

# Montageblech für Stahlkorpen

## Mounting set for steel doors

Das Zubehör Set ist für das Fallenschloss und für die Montage auf Blechtüren geeignet. Das Schloss, die externe Antenne und eventuell der Riegeladapter bitte separat bestellen.

the accessories of the latch lock is suitable for mounting on metal sheet doors. The lock, the external antenna and possibly the bolt adapter to be ordered separately.

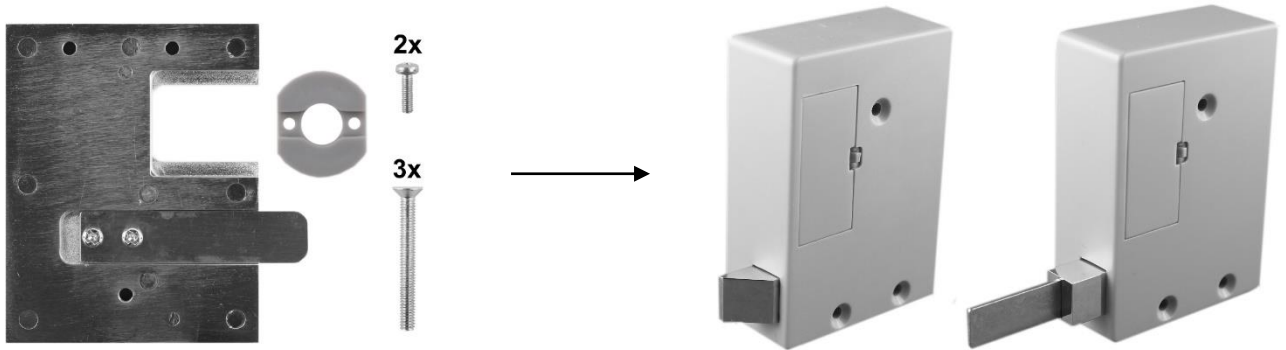

Set:

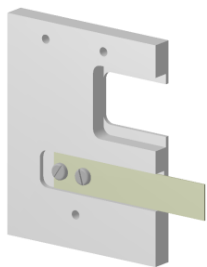

Grundplatte  
baseplate



Befestigungsstutzen  
fixing tool



Schrauben B  
screw B



Schrauben A  
screw A

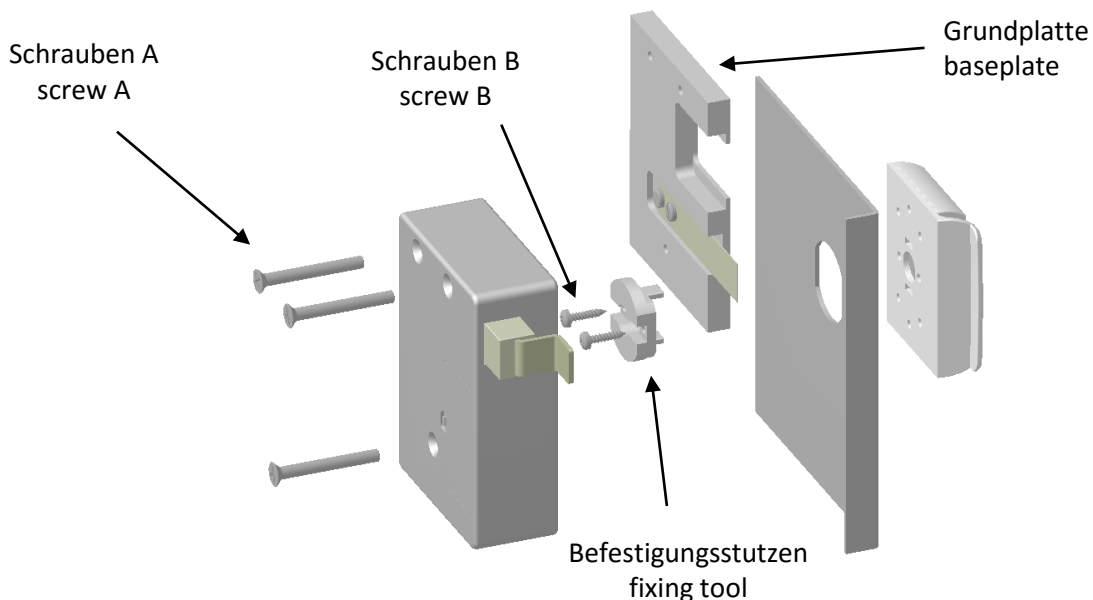

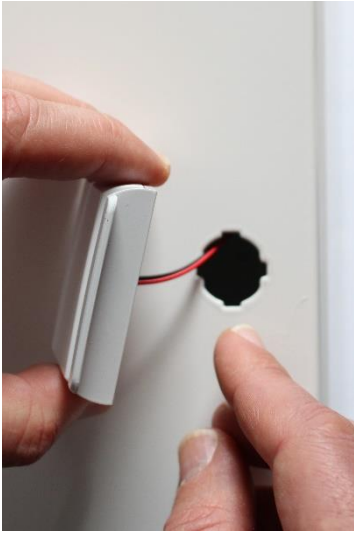

1

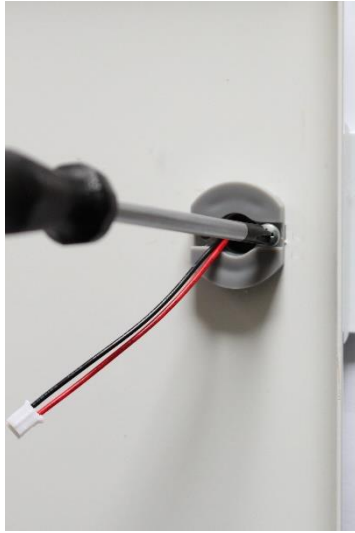

2

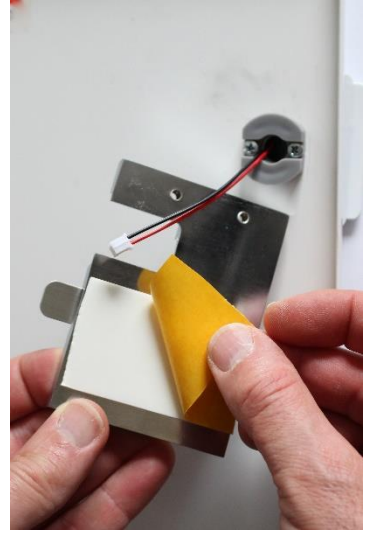

3



4



5



6

